

| ITEM | QTY | DESCRIPTION | MATERIAL |
|------|-----|---|---|
| 1 | 1 | EARTH BAR, 50 mm x 6 mm x 260 mm | TINNED COPPER |
| 2 | 2 | M10 HEX NUT | STAINLESS STEEL 316 |
| 3 | 2 | M10 FLAT WASHER | STAINLESS STEEL 316 |
| 4 | 2 | M10 SPRING WASHER | STAINLESS STEEL 316 |
| 5 | 2 | M10 x 25 SET SCREW | STAINLESS STEEL 316 |
| 6 | 2 | CRIMP LUG, 120 mm ² , 10 mm ϕ | TINNED COPPER |
| 7 | 1 | UBOLT-CLAMP | STAINLESS STEEL 316, HIGH STRENGTH COPPER ALLOY |

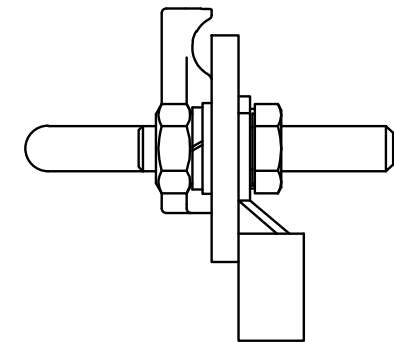
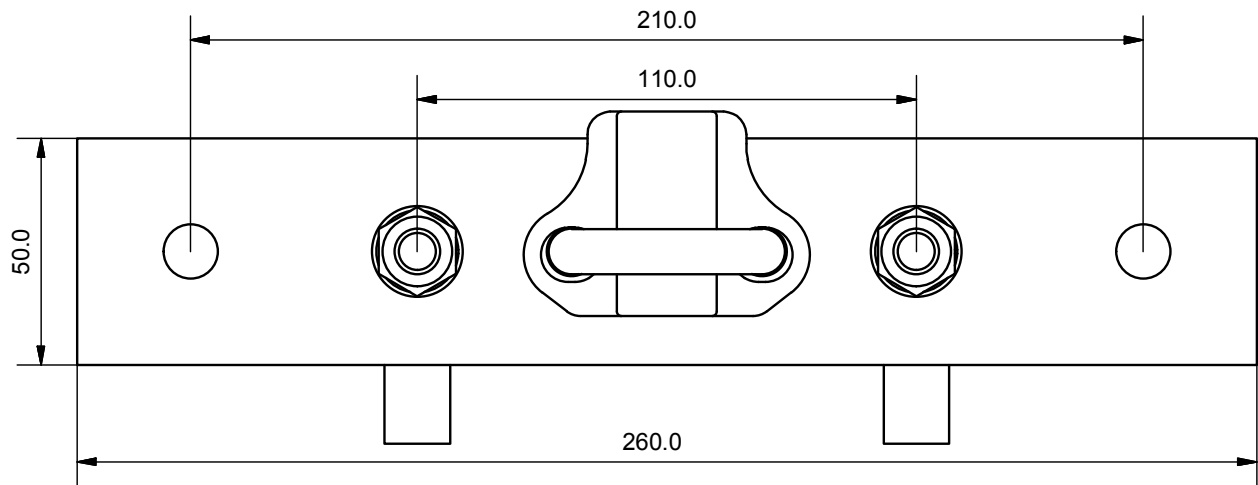
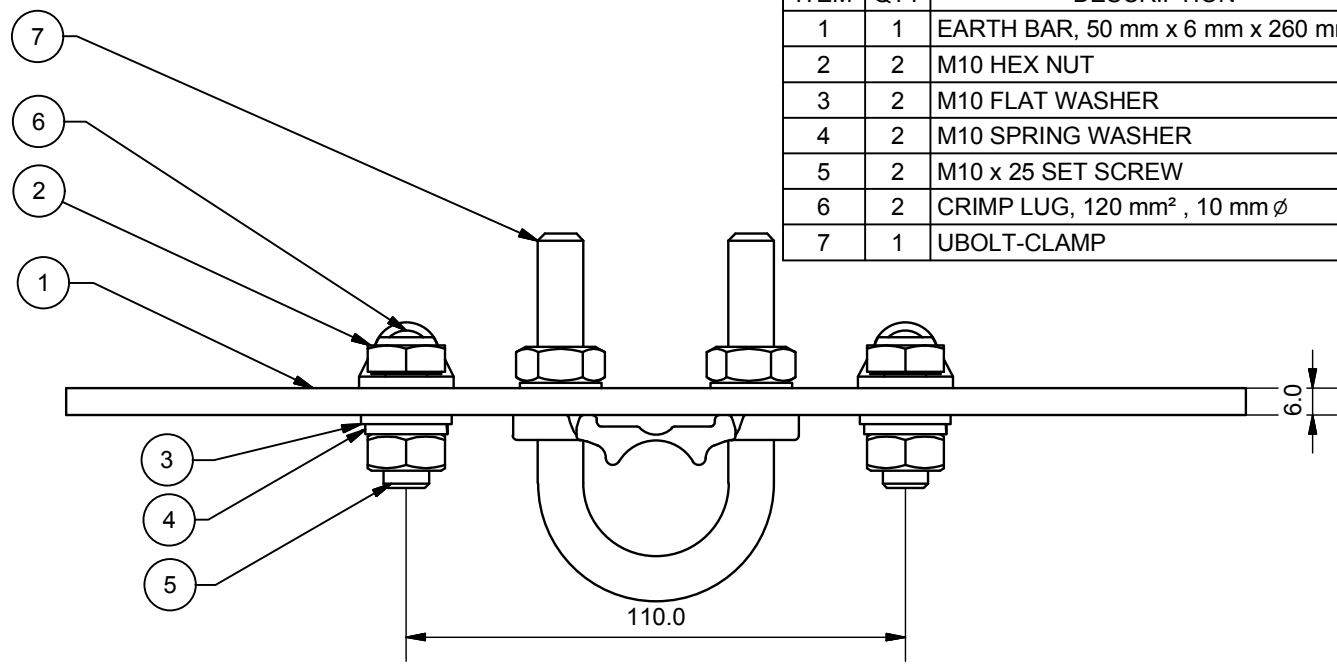

LPI[®]
WWW.LPI.COM.AU

TOLERANCES
UNLESS OTHERWISE STATED
X. ± 1.0
X.X ± 0.5
X.XX ± 0.25

LIGHTNING PROTECTION INTERNATIONAL PTY. LTD.
A.B.N. 11 099 190 897
49 PATRIARCH DRIVE
HUNTINGFIELD TAS 7055, AUSTRALIA
PH: +61 3 6227 1955 FX: +61 3 6229 1900
© 2014 LIGHTNING PROTECTION INTERNATIONAL PTY. LTD.

| | | |
|--------------------------------------|----------------|-----------------|
| TITLE: EB260-TC LPI EXTERNAL DRAWING | | |
| PRODUCT CODE | EB260-TC | REV 1 |
| SCALE | NTS | SHEET 1 OF 1 A4 |
| FILE | EB260-TC.E.IDW | DATE 30/03/15 |