

PARTS LIST

| ITEM | QTY | DESCRIPTION | MATERIAL |
|------|-----|---------------------|----------|
| 1 | 2 | HEX NUT, M10 | SS 316 |
| 2 | 1 | SPRING WASHER, M10 | SS 316 |
| 3 | 2 | FLAT WASHER, M10 | SS 316 |
| 4 | 1 | EARTH BOSS | SS 316 |
| 5 | 1 | STUD, M10 x 60 LONG | SS 316 |

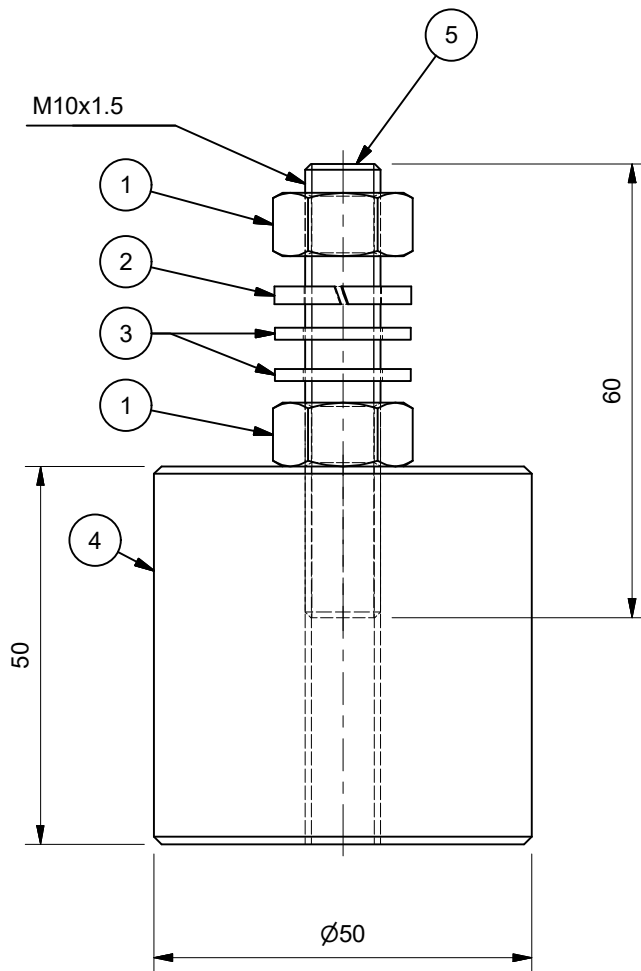

WWW.LPI.COM.AU

| TOLERANCES UNLESS OTHERWISE STATED | |
|---------------------------------------|-------|
| X. | ±1.0 |
| X.X | ±0.5 |
| X.XX | ±0.25 |

LIGHTNING PROTECTION INTERNATIONAL PTY. LTD.

A.B.N. 11 099 190 897

49 PATRIARCH DRIVE
HUNTINGFIELD TAS 7055, AUSTRALIA
PH: +61 3 6227 1955 FX: +61 3 6229 1900

© 2018 LIGHTNING PROTECTION INTERNATIONAL PTY. LTD.

| | | |
|--|-------------------|------------------|
| TITLE: Earth Boss, 50mmØ x 50mm 316, M10 316 stud, Flat & Spring Washer, nut and Locknut | | |
| PRODUCT CODE | EB5010SS316 | REV 1 |
| SCALE | 1 : 1 | SHEET 1 OF 1 |
| FILE | EB5010SS316.E.idw | DATE 25/07/18 |