

ITEM	QTY	DESCRIPTION	MATERIAL
1	1	FLEXIBLE CONNECTOR	TINNED COPPER BRAID, 25 mm x 3.5 mm
2	2	END SWAGE	316 STAINLESS STEEL ANNEALED, SEAMLESS TUBE, M10

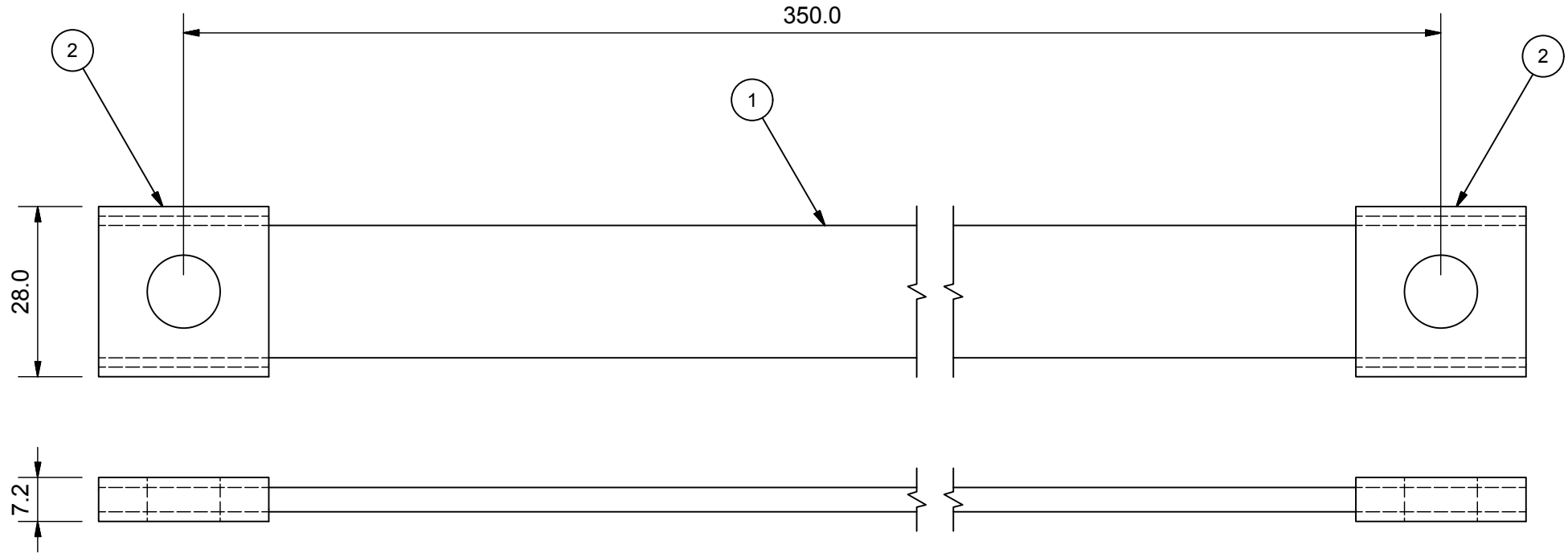

**LPI**<sup>®</sup>  
WWW.LPI.COM.AU

TOLERANCES  
UNLESS OTHERWISE STATED  
X. ± 1.0  
X.X ± 0.5  
X.XX ± 0.25

LIGHTNING PROTECTION INTERNATIONAL PTY. LTD.  
A.B.N. 11 099 190 897  
49 PATRIARCH DRIVE  
HUNTINGFIELD TAS 7055, AUSTRALIA  
PH: +61 3 6227 1955 FX: +61 3 6229 1900  
© 2015 LIGHTNING PROTECTION INTERNATIONAL PTY. LTD.

TITLE: LPI Tinned Flexible Connector 350 mm

PRODUCT CODE	FL5TFC350C	REV	1
SCALE	NTS	SHEET	1 OF 1
FILE	FL5TFC350C.E V1.idw	DATE	28/04/15